



Rainwater Dissipation Chamber Specification

Dissipation Chamber

Product Code: 1700602

The Skeletank rainwater dissipation chamber is available in 500mm Ø. The dissipation chamber has 4 160mmØ spigots. These are positioned at 90° to each other.

Any of the spigots can be used as an inlet / outlet. The chamber spigots are sized to fit standard underground push-fit pvc drainage sockets.

The filter chamber has a 200mm deep sump to accommodate the deposition of silt and debris in the collected rainwater for later removal under a regular maintenance regime.

The chamber is supplied with a polypropylene cover and frame (35kN loading)

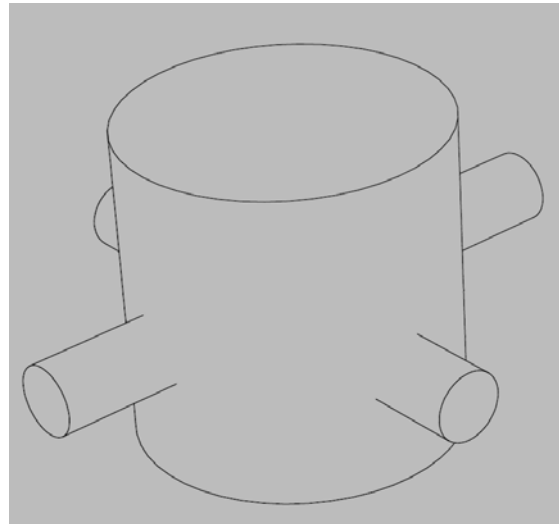

Element	500mm Ø
<u>Dimensions</u>	
Chamber diameter (mm)	500
Sump depth (mm)	200
Overall depth (mm)	620
Number of spigots	4
Spigot diameter (mm)	160
Material	Polypropylene

Disclaimer

This product specification is neither giving nor implying warranty for the use of this information for design and installation, as these are beyond our control. The data provided is typical and based upon the mean values obtained from the samples taken for any one test. If not otherwise indicated the test procedures reflect usually the mean of five samples. Skeletank Limited reserve the right to change the specifications without prior notice. Skeletank® is a trade mark registered by Skeletank Limited.

**Skeletank Limited,
Stormal Hill Works, Tottington,
Bury, Lancashire
BL8 4AT**

**Telephone: 0845 177 1535
Fax: 01204 885533
E-Mail: sales@skeletank.co.uk
Web: www.skeletank.co.uk**